

Lodging at SUNY Oneonta—Wilber Hall

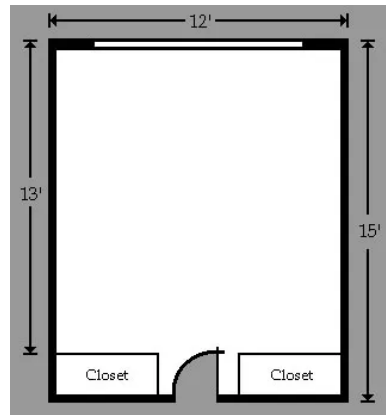

By staying on the grounds you will have access to your room whenever you want, i.e. after meals and in between workshops, without having to drive.

There are no ensuite bathrooms, they are down the hall and shared.

There are **NO** elevators. If you have a disability that prevents you from using stairs please note this on the Special Needs section of the registration page.

Linens (standard twin size bed) are included in the price of lodging:

Included: pillow/pillowcase, fitted sheet, sheet, a towel, and a washcloth

Here are some things you might want to bring (optional)

- Hair Dryer
- Alarm Clock
- Toiletries
- Towels
- Blanket
- Your own pillow

Local Hotels

Hampton Inn, 225 River St, Oneonta [607-433-9000](tel:6074339000)

Holiday Inn Express, 141 Courtyard Dr., Oneonta, [607-684-2000](tel:6076842000)

Courtyard Marriott, 116 Courtyard Dr., Oneonta [607-432-2200](tel:6074322200)

Apparel Options for the 2023 Conference

The 2023 logo will be embroidered onto the apparel.
For the logo, see the front of the conference brochure.

Tee shirt or hoodie color choices: Light Blue or Heather Gray



**Tee shirt
sizes S-4X**

\$20

A reliable choice for comfort, softness and durability. 5.5-ounce, 50/50 cotton/poly.



**Full-Zip Hooded Sweatshirt
sizes – S-4X**

\$40

Platinum Tri-blend Lightweight hoodie

HOW TO MEASURE

CHEST WIDTH

Measure under the arm and around the fullest part of the chest with arms down, keeping tape horizontal.

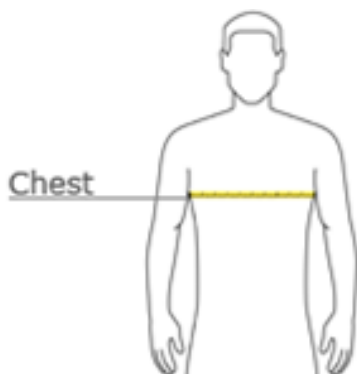

SIZE CHART

	S	M	L	XL	2XL	3XL	4XL
Chest	35-37	38-40	41-43	44-46	47-49	50-53	54-57

Support the NYSLAA Conference

Do you enjoy the NYSLAA basket raffle?

Please consider taking your enjoyment to the next level by donating a basket



We want to see your creative side!

Gather your ideas and items and put them together to make a basket for us to enjoy this year.

Let me know if you are planning to donate a basket this year by emailing me at the address below.

Cathy.Fallon@oneonta.edu

Do you enjoy the NYSLAA 50/50 Raffle?

YOU COULD BE A



Help support the NYSLAA conference.

Participate in the 50/50 Raffle.

15 tickets for \$5.00.

There are 4 opportunities to win, so bring your cash.



Important Information

- To sign up for a NYSLAA Certificate of Achievement one-on-one consultation at the conference, contact Kathy Rossello. To set up an appointment, email Kathy at rossek@eglibrary.org or call 518-477-7476 ext. 108.
- **\$\$\$** The 2023 Conference Committee is carrying on the ever popular lottery tradition. Bring New York State Lottery scratch-off tickets for someone to win. More tickets means more fun and more potential for a big jackpot! Ticket donors will receive one raffle ticket for each dollar value of the lottery ticket they donate, **up to \$5. \$\$\$**
- Don't forget, if you purchased a NYSLAA permanent Name Badge Holder, bring it with you. If you would like to purchase one they will be available at the Registration Table for \$3.00.
- For directions <https://tinyurl.com/5n6k8dpw>
- If you've signed up for a tour on Wednesday, you will need to be in the area near registration no later than 12:30 for the Rail Explorers in Milford or the Fenimore Art Museum/Farmer's Museum. If you need a ride, please indicate so under the special needs section of the registration page.



Want to help support local interests? Our Community Outreach Committee is supporting these local organizations. Please help out one or more of the following:

- **Super Heroes Humane Society** – cat litter, dog and cat food, paper towels and laundry soap are needed. We will have a donation jar for the shelter at the registration table for cash, or checks made payable to NYSLAA.
- **Catholic Charities of Otsego County** -personal hygiene items such as: shampoo, feminine products, deodorant, toothbrushes, toothpaste, razors. They also need adult socks, winter coats, and backpacks. Food items are welcome as well as gift cards to Subway, Aldi's or Wegmans. Monetary donations are always welcome. We will have a donation jar at the registration table for cash, or checks made payable to NYSLAA.
- If you've collected toiletries from your travels that you'd like to donate for the homeless and women's shelters, we will also have a box for these items at registration. If you are staying at a hotel, please bring over your extras daily.

